

8'-0" min.

top of subfloor

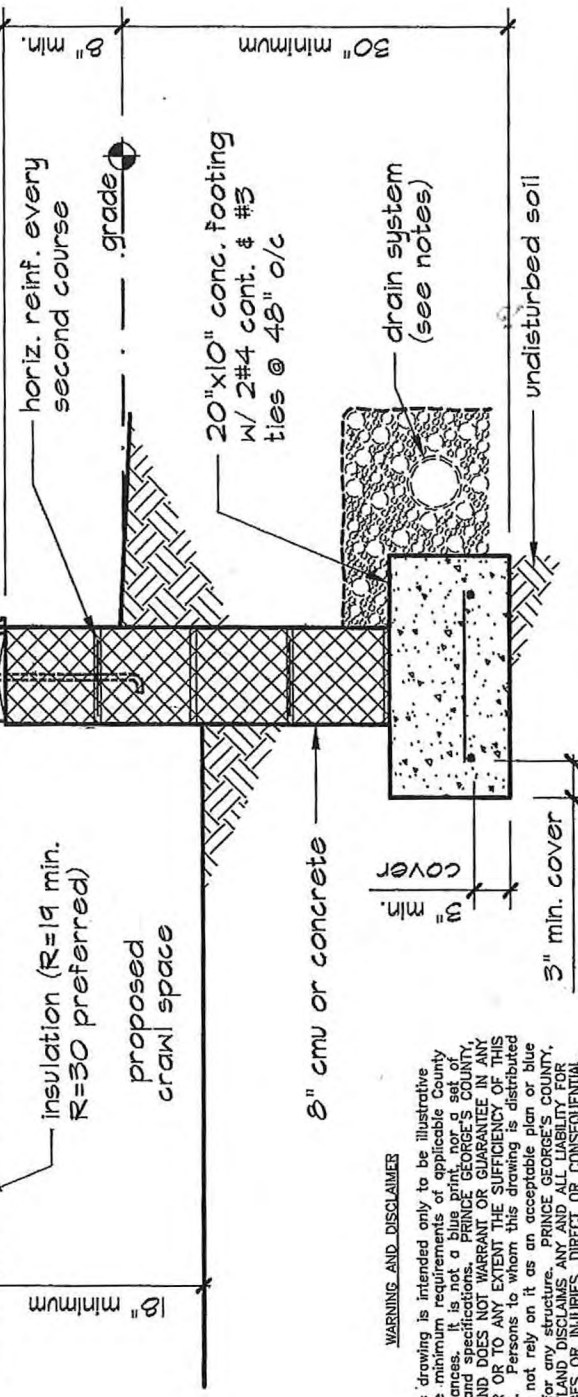

3" min. cover

8" min. cover

Foundation Notes

- 1.) minimum compressive strength of concrete shall be 2500 psi.
- 2.) provide one 8"x16" vent louvre for every 10 square feet of crawl space area. locate one vent within 3-feet of each corner.
- 3.) provide crawl space access (minimum 24" wide by 18" high).
- 4.) when crawl space is below outside grade, provide 4" drain tile in 12"x12" washed gravel covered w/ filter fabric. drain to daylight.

SAMPLE

WARNING AND DISCLAIMER
 This drawing is intended only to be illustrative of the minimum requirements of applicable County ordinances. It is not a blue print, nor a set of plans and specifications. PRINCE GEORGE'S COUNTY, MARYLAND DOES NOT WARRANT OR GUARANTEE IN ANY MANNER OR TO ANY EXTENT THE SUFFICIENCY OF THIS DRAWING. Persons to whom this drawing is distributed should not rely on it as an acceptable plan or blue print for any structure. PRINCE GEORGE'S COUNTY, MARYLAND DISCLAIMS ANY AND ALL LIABILITY FOR DAMAGES OR INJURIES, DIRECT OR CONSEQUENTIAL, ARISING OUT OF THE USE OF THIS DRAWING.

Drawing No.

D-101

Sheet 1 Of 2

**WALL SECTION
 @ CRAWL SPACE**



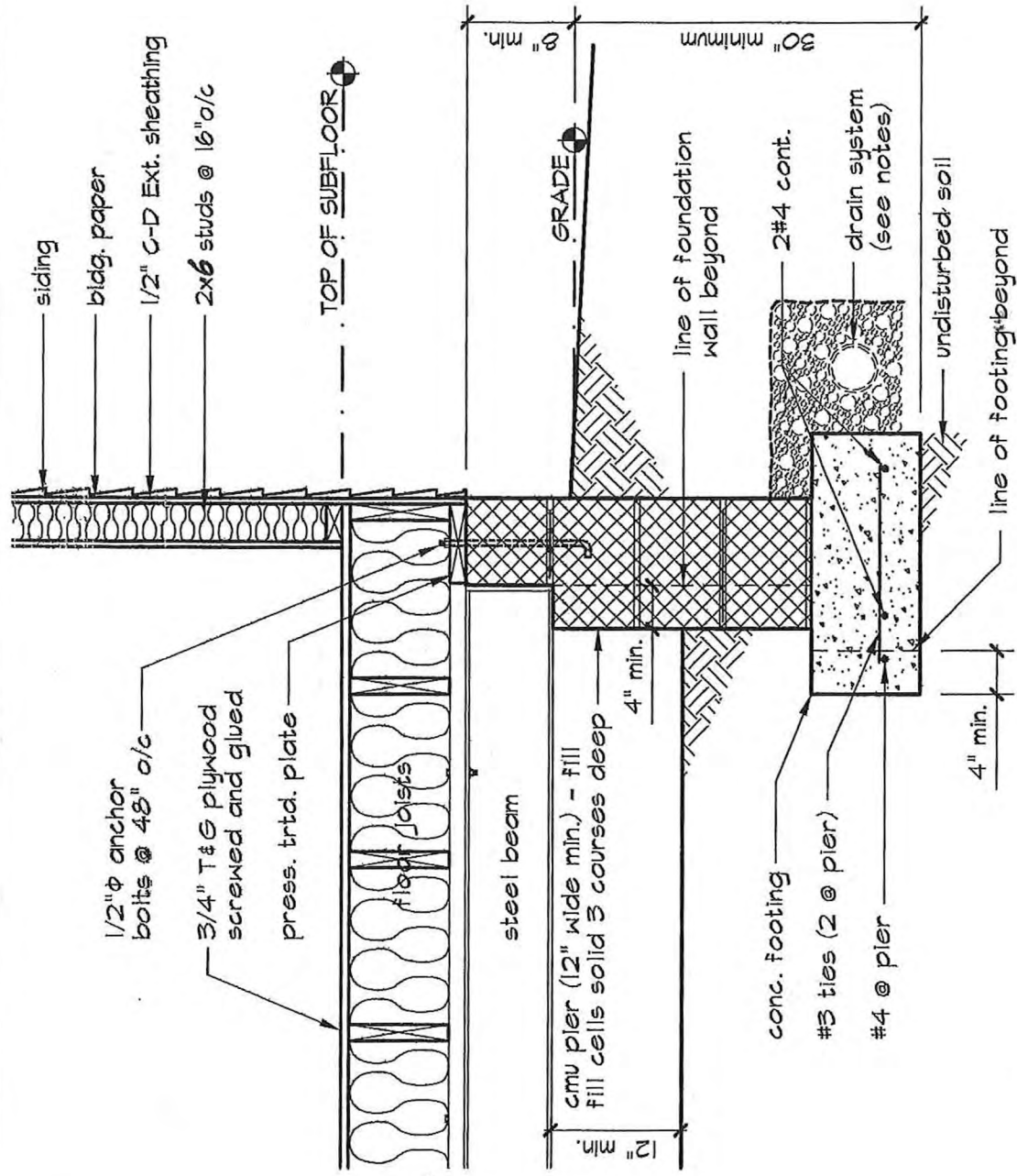

MASONRY PIER ENGAGED TO FOUNDATION WALL

bolt wood plate to top flange w/ 3/8" diameter thru bolts @ 32" on center staggered

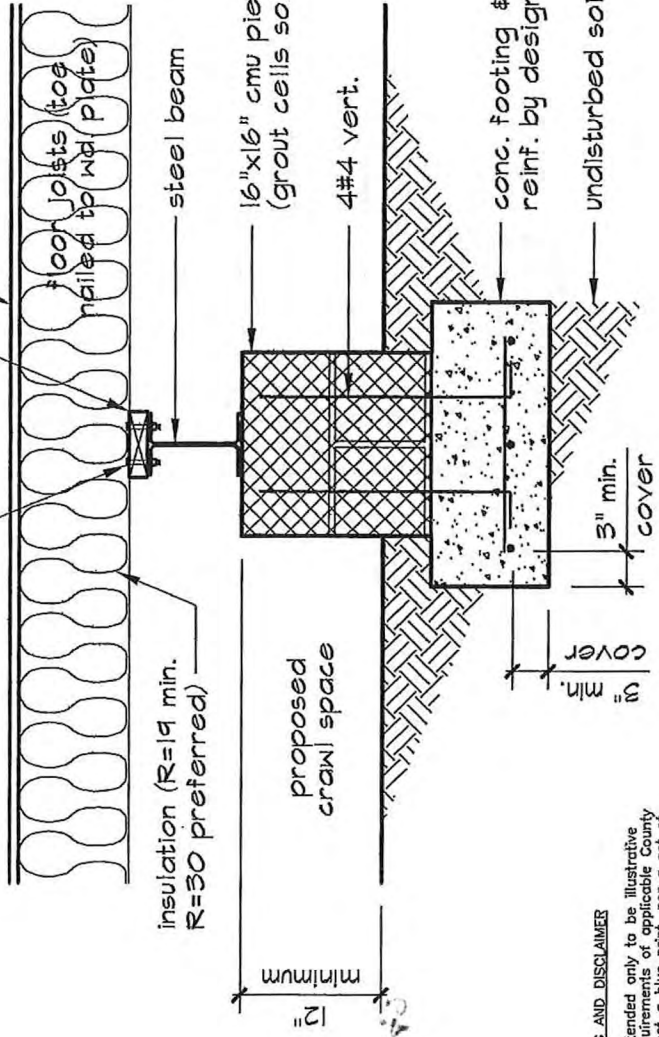

INTERIOR PIER

WARNING AND DISCLAIMER
 This drawing is intended only to be illustrative of the minimum requirements of applicable County ordinances. It is not a blue print, nor a set of plans and specifications. PRINCE GEORGE'S COUNTY, MARYLAND, SHALL BE RESPONSIBLE IN ANY MANNER OR TO ANY EXTENT THE SUPERIOR OF THIS DRAWING. Persons to whom this drawing is distributed should not rely on it as an acceptable plan or blue print for any structure. PRINCE GEORGE'S COUNTY, MARYLAND, DISCLAIMS ANY AND ALL LIABILITY FOR DAMAGES OR INJURIES, DIRECT OR CONSEQUENTIAL, ARISING OUT OF THE USE OF THIS DRAWING.

SAMPLE

